

MAP KEY

★ Main entrance	○ Classrooms	≡ Stairs
ⓘ Information	○ Outdoor spaces	Ⓜ Elevators
💧 Water stations	○ Art installations	Ⓜ Restrooms
○ Exhibits	○ Event spaces	▭ Viewing areas
○ Selfie Spots	○ Conference rooms	▭ Research/staff areas

FLOOR 1

★ Main entrance

- 1 Terra Lobby
- 2 Living wall
- 3 Sunflower exhibit
- 4 Controlled Environment Horticulture
- 5 Food Systems exhibit
- 6 Terra Kitchen
- 7 Sensory testing lab

- 8 Dairy lab
- 9 Produce lab
- 10 Meat lab
- 11 Careers exhibit
- 12 Food Innovation exhibit
- 13 Community Food Justice Garden
- 14 North plaza
- 15 *The Bale*

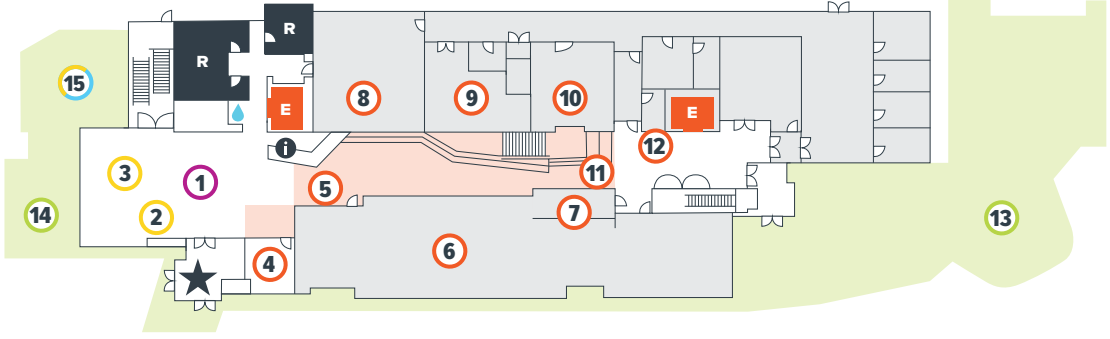

FLOOR 2

- 1 Controlled Environment Horticulture lab
- 2 Pueblo Chile conference room
- 3 Palisade Peach conference room
- 4 CSU Spur offices
- 5 CSU Resilience Center

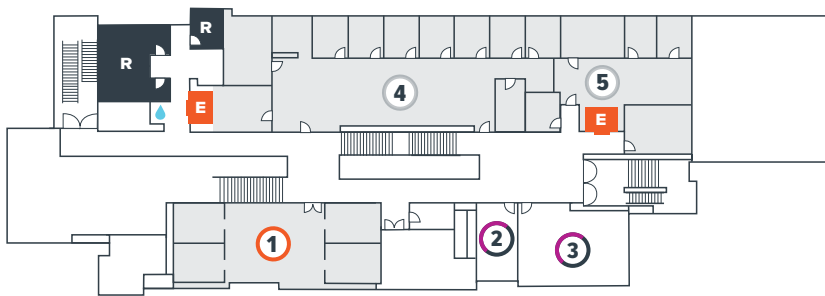

FLOOR 3

- 1 Ag Discovery exhibits
- 2 CSU Impact map
- 3 Kid's Kitchen
- 4 Pumpkin classroom
- 5 Alfalfa classroom
- 6 Morgridge Learning Lab
- 7 Soil sample drop-off
- 8 Microbiology lab
- 9 Molecular Biology lab
- 10 Water lab
- 11 Instrument lab
- 12 Soil/Plant lab
- 13 CSU Spur offices
- 14 Bridge to Hydro (opening 2023)

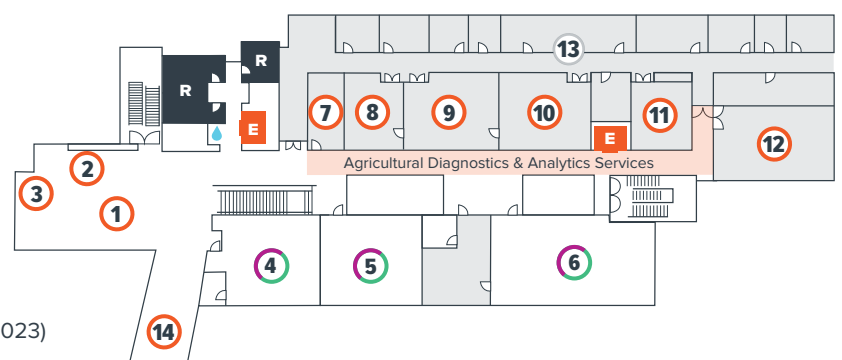

FLOOR 4

- 1 *Tomorrow's Food*
- 2 Ag Discovery exhibits
- 3 Indoor Garden Terrace
- 4 Outdoor Garden Terrace
- 5 Research Green Roof
- 6 Greenhouse

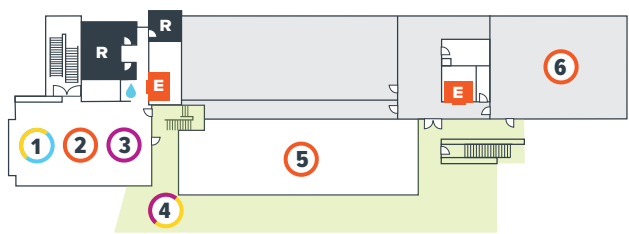

FLOOR 5

- 1 Indoor Hops Terrace
- 2 Outdoor Hops Terrace
- 3 Green Roof

